

BANTAM® CORIOLIS™
Baitcasting Reels

Style

- XT-7 Composite Frame
- Aluminum Spool
- Calibrated Magnetic Spool Control
- QuickFire II® Clutch Bar
- 2 Stainless Steel Ball Bearings
- 5.1:1 Gear Ratio

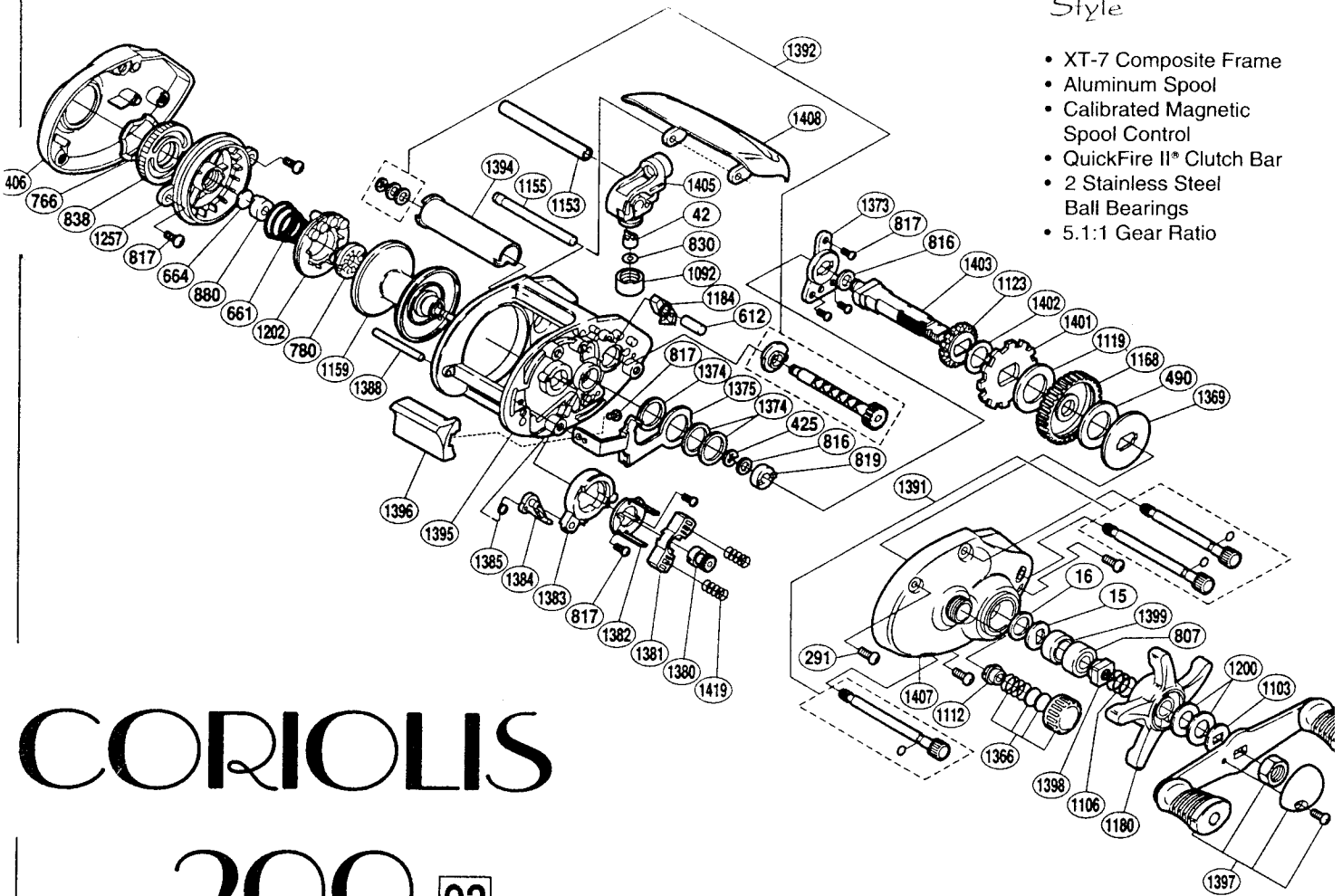

CORIOLIS

200 93

EXPLODED PARTS VIEW

MODEL NO.	LINE / CAPACITY	GEAR RATIO	WT. (OZ.)	BEARINGS
CO-200A	10/210, 12/150, 14/140	5.1:1	9.2	2-ball

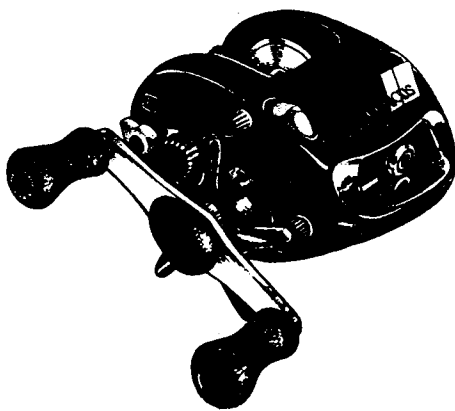

Coriolis™ has plenty of style. It has a sleek design, only the necessary features, and solid operation - a real pleasure to fish. In fact, the Coriolis™ and Citica™ are very similar. The differences between them is color and the anti-reverse. Coriolis™ has a standard dog and pawl anti-reverse system instead of Citica's SuperStopper™.

Why would we make two similar reels? We feel both these reels appeal to a large number of people. All want a modern, quality reel, but some are more sensitive to price. With the Coriolis they get quality and style at a very good price.

PART #	DESCRIPTION	*A* INTERCHANGEABILITY	*B* INTERCHANGEABILITY
BNT0015	Drag Spring Washer		
BNT0016	Friction Washer (C)		
BNT0042	Line Guide Pawl		
BNT0291	Right Side Plate Screw	BR 0046, RD 0345	BB 0061, BNT0191, KXB0052, MLX0049, RD 0050, X/20147
BNT0425	*E* Lock	BB 0037, BNT0234, BR 0326, RD 1673, TGT0042, TLD0137, TRN0091, TT 0096	BR 0117, RD 0476
BNT0490	Drag Washer (B)		
BNT0612	Anti-Reverse Pawl Pin		
BNT0661	Magnet Retainer Spring		
BNT0664	Spacer (B)		
BNT0766	Dial Friction Washer		
BNT0780	Magnet Retainer Lock		
BNT0807	Drive Shaft Bearing (B)	BR 0037, KXB0028, MLX0025, RD 0026, TGT0223, TLD0123, TT 0117	
BNT0816	Drive Shaft Washer		
BNT0817	Multi Purpose Screw		
BNT0819	Drive Shaft Bushing		
BNT0830	Spacer (optional)		
BNT0838	Magnetic Control Dial		
BNT0880	Spool Shaft Bushing (B)		
BNT1092	Pawl Cap	TGT0227	BNT1236
BNT1103	Friction Washer (A)		
BNT1106	Star Drag Spring		
BNT1112	Spool Shaft Bushing (A)		
BNT1119	Drag Washer (A)		
BNT1123	Idle Gear		
BNT1153	Stabilizer Bar		
BNT1155	Thumb Rest Support		
BNT1159	Spool Assembly		
BNT1168	Drive Gear		
BNT1180	Star Drag		
BNT1184	Anti-Reverse Pawl		
BNT1200	Star Drag Spacer		
BNT1202	Magnet Retainer		
BNT1257	Dial Case		
BNT1366	Cast Control Cap Assembly		
BNT1369	Key Washer		
BNT1373	Drive Shaft Retainer		
BNT1374	Clutch Plate Washer		
BNT1375	Clutch Plate		
BNT1380	Pinion Gear		
BNT1381	Yoke		
BNT1382	Clutch Cam Retainer		
BNT1383	Clutch Cam		
BNT1384	Clutch Pawl		
BNT1385	Clutch Pawl Spring		
BNT1388	Clutch Bar Support		
BNT1391	Side Plate Bolts Assembly		
BNT1392	Worm Shaft Assembly		
BNT1394	Level Wind Guard		
BNT1395	One-Piece Frame		
BNT1396	Quick-Fire II Clutch Bar		
BNT1397	Handle Assembly		
BNT1398	Star Drag Nut		
BNT1399	Friction Washer (B)		
BNT1401	Anti-Reverse Ratchet		
BNT1402	Idle Gear Spacer		
BNT1403	Drive Gear		
BNT1405	Line Guide		BNT1378
BNT1406	Left Side Plate		
BNT1407	Right Side Plate		
BNT1408	Thumb Rest		
BNT1419	Yoke Spring		